

## C. R. Ettinger Studio Selections from 2000 to 2010

January 29 - April 18, 2010

School of the Fine Arts Gallery: Gift of the  
Women's Board

As part of the *Philagrafika 2010* festival, this exhibition brings together collaborative works by 25 artists and Master Printer Cindi Royce Ettinger. Artists include, among others, Bill Scott, David Fertig, Celia Reisman, Astrid Bowlby, Virgil Marti, Sarah McEneaney, Isaiah Zagar, and Neil Welliver.

Established in 1982, the C. R. Ettinger Studio specializes in intaglio and relief techniques and accommodates monoprinting. It is the only professional etching studio in the Philadelphia area. All artwork is original and produced collaboratively with the artist and Ms. Ettinger, a Master Printer for over three decades.

## Public Treasure/Private Visions: Hudson River School Masterworks from the Metropolitan Museum of Art and Private Collections

June 15, 2009 - May 30, 2010

Gallery 11, Historic Landmark Building



The Hudson River School is one of the foundational and most influential traditions in the history of American landscape painting. This exhibition features glorious, romantic visions of the Hudson River and the American West.

On display are paintings of turbulent storms, icebergs, quiet sunsets, and harvest scenes of plenty by ten noted Hudson River School artists. View rare treasures from the Metropolitan Museum of Art and stellar private collections.

Above: Frederic E. Church, *Icebergs and Wreck in Sunset*, ca.1860, Oil on paperboard mounted on canvas, 8 1/4 x 12 1/4", Private Collection

Funding for *Public Treasure/Private Visions: Hudson River School Masterworks from the Metropolitan Museum of Art and Private Collections* is provided by Newington-Cropsey Foundation.

## Philagrafika 2010: The Graphic Unconscious

January 29 - April 11, 2010

Fisher Brooks Gallery, Samuel M.V.  
Hamilton Building and Morris Gallery,  
Historic Landmark Building.



Tromarama, *Serigala Militia*, 2005 (detail), Woodcuts and DVD projection, One from a series of 402 woodcuts, each 8.3 x 11 in., Image courtesy of the artists

The core exhibition of the *Philagrafika 2010* festival, **The Graphic Unconscious** is a five-venue project, simultaneously shown at PAFA, The Philadelphia Museum of Art, The Galleries at Moore College of Art & Design, the Temple Gallery at Tyler School of Art, and The Print Center. Presenting 35 internationally renowned artists and artist groups from 18 countries, **The Graphic Unconscious** explores the ubiquitous presence of printed matter in our visual culture and how concepts like accessibility, democratization, dissemination,

and transience inform diverse contemporary art practices while expanding the realm of printmaking itself. In media ranging from woodcuts to videos, at PAFA, **The Graphic Unconscious** presents seven artists from three continents: Christiane Baumgartner (Germany); Mark Bradford (USA); Orit Hofshi (Israel); Pepón Osorio (USA); Kiki Smith (USA); Tromarama (Indonesia); and Qiu Zhijie (China).

This exhibition at PAFA is organized as part of the multi-site exhibition *Philagrafika 2010: The Graphic Unconscious* in collaboration with Philagrafika, a nonprofit arts organization in Philadelphia that provides leadership for large-scale, collaborative initiatives with broad public exposure. Program support for *The Graphic Unconscious* is provided by The Pew Center for Arts & Heritage through the Philadelphia Exhibitions Initiative, The Andy Warhol Foundation for the Visual Arts and the National Endowment for the Arts.

Leading support for PAFA's participation in *Philagrafika 2010: The Graphic Unconscious* is provided by RBC Wealth Management, and by the William Penn Foundation. The presentation of work by Orit Hofshi at PAFA is co-sponsored by Israel Foreign Ministry, Consulate General of Israel, Philadelphia. Additional support for the presentation of work by Christiane Baumgartner at PAFA is provided by the IFA Institut für Auslandsbeziehungen e.V.



RBC Wealth Management

ifa

Institut für Auslandsbeziehungen e.V.



## 109th Annual Student Exhibition

May 15 - June 6, 2010

Galleries of the Samuel M.V. Hamilton Building

At the *109th Annual Student Exhibition (ASE)*, works by BFA students, third-year and fourth-year Certificate Program students, and Master of Fine Arts candidates, will showcase a diversity of styles that combine traditional skill and con-

temporary vision. In addition to its role as an exhibition and sale, the exhibition represents a competition for the coveted Certificate Program's Cresson, Schiedt, Von Hess, Ware, and Women's Board Travel Scholarships.



# gallery guide



## Museum Hours

Tuesday - Saturday, 10 a.m. - 5 p.m.  
Sunday, 11 a.m. - 5 p.m.

## Admission

**Admission to the Permanent Collection**  
Adults \$10; Seniors & Students with I.D. \$8  
Youth ages 5 - 18 \$6

## Admission to Special Exhibitions

(includes the Permanent Collection)  
Adults \$15; Seniors & Students with I.D. \$12  
Youth ages 5 - 18 \$10

FREE for members and children under 5.  
Morris Gallery exhibitions and the ground floor  
of the Historic Landmark Building are free.

## Tours

Tuesday, Thursday, Friday 11:30 a.m. and  
12:30 p.m.; Wednesday, Saturday, Sunday  
1 p.m. and 2 p.m.

## Portfolio at the Pennsylvania Academy®

Monday - Saturday, 10 a.m. - 6 p.m.  
Sunday, 11 a.m. - 6 p.m.

## Academy Café

Tuesday - Saturday, 10 a.m. - 2:30 p.m.  
Sunday, 11 a.m. - 2:30 p.m.

## Membership

Members enjoy free admission and other  
benefits. Information: 215-972-0522 or  
www.pafa.org/join

## Continuing Education

Information on courses:  
215-972-7632 or www.pafa.org/ce

## Children's & Family Programs

Saturday Family Workshops, Children's  
Saturday Art Classes, and Art Enrichment  
Class for All Ages. Information: 215-972-2061  
or www.pafa.org/Museum/Education/36

Cover: Mark Bradford (*American*, born 1961), *Untitled (Dementia)*, 2009, Mixed media collage, Overall 114 x 67.5 inches, Photo courtesy of Sikrema Jenkins & Co., New York

# Historic Landmark Building

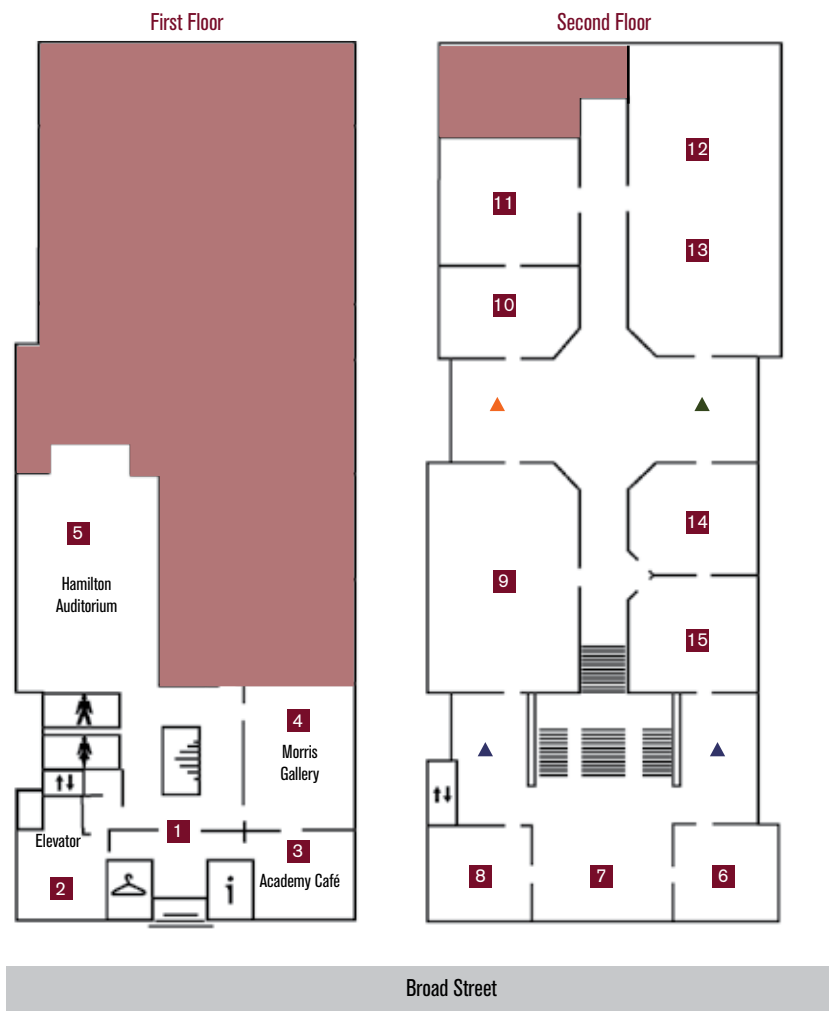

# Samuel M. V. Hamilton Building

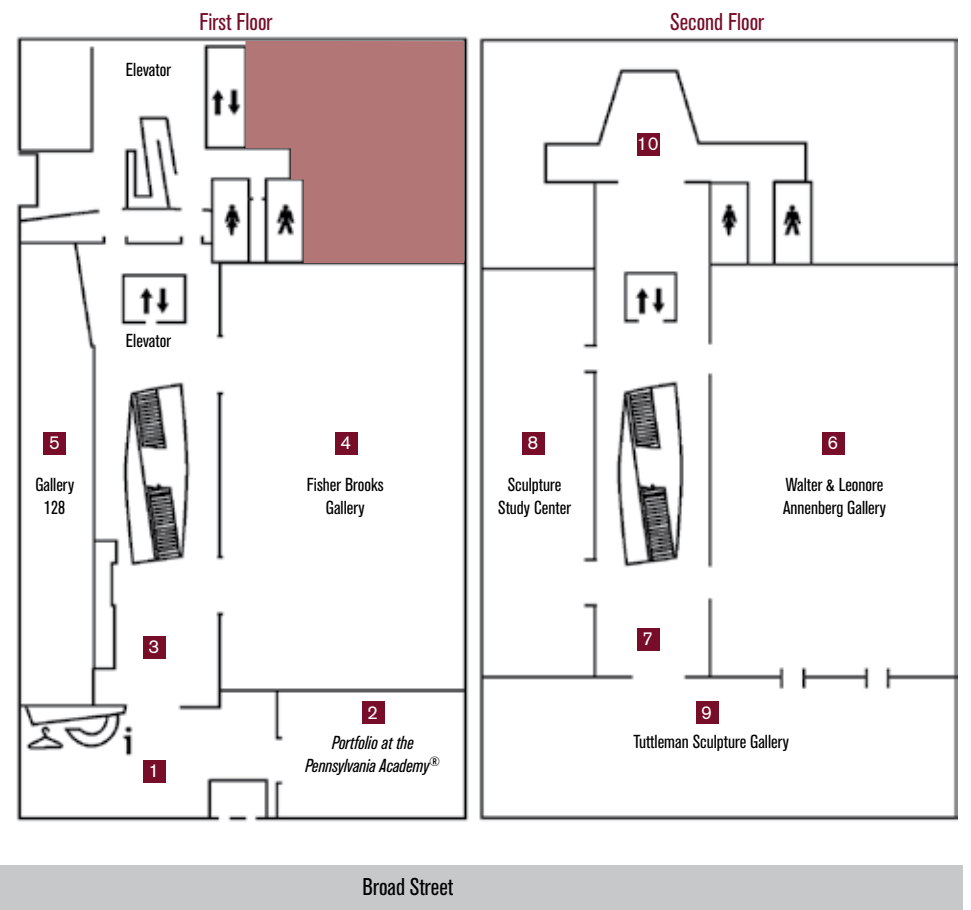

## FIRST FLOOR

1. Foyer
2. Discovery Room
3. Academy Café
4. Morris Gallery:  
*Philagrafika 2010: The Graphic Unconscious* (Jan. 29 - Apr. 11, 2010)
5. Hamilton Auditorium

## SECOND FLOOR

6. Art of the Colonial Period
7. Washington Foyer:  
Portraying a New Nation
8. Charles Willson Peale & His Family
9. The Age of Democracy and the "Common Man"
10. 19th Century Landscape Painting
11. *Public Treasures/Private Visions: Hudson River School Masterworks from the Metropolitan Museum of Art and Select Private Collections* (through May 30, 2010)
12. Portraiture in the Gilded Age
13. American Impressionism and Realism
14. Modernism in America
15. The Vivian O. and Meyer P. Potamkin Gallery

- ▲ History Paintings by Benjamin West
- ▲ Civil War
- ▲ The Beginnings of American Modernism

\*To review the artwork in chronological order, visit Galleries 6-14.  
\*Shaded areas are not open to the public.



## FIRST FLOOR

1. Foyer
2. *Portfolio at the Pennsylvania Academy®*
3. Foyer Gallery:  
*Push, Press, and Pull: Prints Since the 1960s* (Through Apr. 11, 2010)
4. Fisher Brooks Gallery:  
*Philagrafika 2010: The Graphic Unconscious* (Jan. 29 - Apr. 11, 2010)  
*109th Annual Student Exhibition* (May 15 - June 6, 2010)  
*Note: this exhibition is also in galleries 5 - 9*
5. Gallery 128

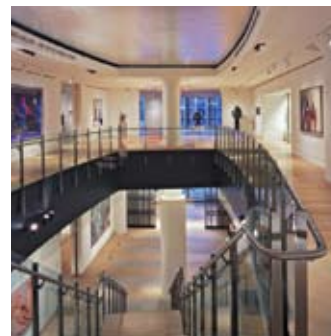

## SECOND FLOOR

6. Walter & Leonore Annenberg Gallery:  
*Push, Press, and Pull: Prints Since the 1960s* (Through Apr. 11, 2010)
7. School of Fine Arts Gallery: Gift of the Women's Board  
*C.R. Ettinger Studio Selections from 2000 - 2010* (Jan. 29 - Apr. 18, 2010)
8. American Sculpture Study Center
9. Tuttleman Sculpture Gallery: Postwar American Art
10. West Gallery:  
Robert Ryman: *Philadelphia Prototype, 2002*

## GALLERY GUIDELINES

In order to protect the artwork and create an enjoyable and safe environment for all visitors, please observe the following gallery guidelines:

- Smoking is prohibited
- Please do not touch the artwork
- Food and drink are allowed only in the Academy Café
- Bags larger than 8"x10"x12" must be checked, smaller bags may be carried or worn on one shoulder
- Umbrellas must be checked
- Sketchbooks may not exceed 12" x 16"
- Only pencils may be used for notetaking or sketching
- Photography is prohibited
- Coats may be worn, or checked (wet coats must be checked)
- Please be considerate when using cellular phones